



# Maine Woodturners

## Newsletter

May 2016



May Demo will feature

## DAMON HARMON

**Back to Basics part 2 !**

### **“HOW TO USE YOUR TURNING TOOLS AND GET GOOD RESULTS”**

- *Spindle Roughing gouge*
- *Parting Tool*
- *Detail gouge*
- *Bowl gouge*
- *Round-nose scraper*
- *Skew*

Damon will take us step by step on the proper usage of these basic woodturning tools and why some of these tools are only used on spindle turnings and not bowls.

**Wednesday – May 18, 2016**

6:30-7:00PM Show & Tell photos and socializing – 7:00PM Demo

All-Purpose Room, Erskine Academy,  
309 Windsor Rd., South China, ME 04358

# SECRETARY'S REPORT

The April 2016 meeting of Maine Woodturners was held at Erskine Academy in South China on Wednesday the 20th. Forty one Members and guests were in attendance.

President Brian Libby opened the meeting at 7 PM by introducing two new club members.

He then opened with a proposed change in the bylaws. He proposed that the bylaws be changed to reflect that the new elected officers take office at the June meeting the members voted to accept the change and it was seconded.

Brian announced that there will be a wood auction tonight and a raffle for a \$50 certificate at Rockler. Tools have been ordered for the two new small lathes now owned by the club.

Brian also stressed the need for a Vice President to come forward at the next meeting. There will be a segmented turning symposium in Quincy, Mass. In October.

Brian introduced Lanny Dean as tonight's demonstrator. Turning a bowl from a section of tree. Lanny started at 7:07 and ended at 8:30.

Brian then hosted the Show and Tell table which was followed by the wood auction and raffle hosted by Treasurer Burt Truman. Burt reports that the raffle brought in \$150, the wood auction \$90, the coffee \$21 and 2 new members and 3 renewals added \$150.

The meeting ended at 8:50.

Tom Raymond, Sec

Election Time is here !

**In the even numbered years we elect the**

***President and Vice-President***

**In order for the club to continue to function**

**We need people to step forward and volunteer.**

## FOR SALE

Professionally built wood drying kiln  
24" wide by 51" tall by 22" deep on wheels  
6 adjustable/removable shelves  
Auto temp control  
Temp and humidity indication  
Heat generated by two light bulbs  
Air circulation via fan

I will never use this kiln as I am a believer in using Tom Raymond's method of using a microwave oven to dry the wood. I desperately need a band saw and am willing to sell this kiln for \$300 so I can put money toward my saw.

I also have a Rockwell Wood Shaper, Model 43-120, on a stand with 34 cutting heads that I would sell for \$130. And, in case, somebody is really interested, I also have an 8 inch Delta compound miter saw that I would give away for \$25.

Dick Picard

[dick\\_picard@yahoo.ca](mailto:dick_picard@yahoo.ca)

# SHOW & TELL

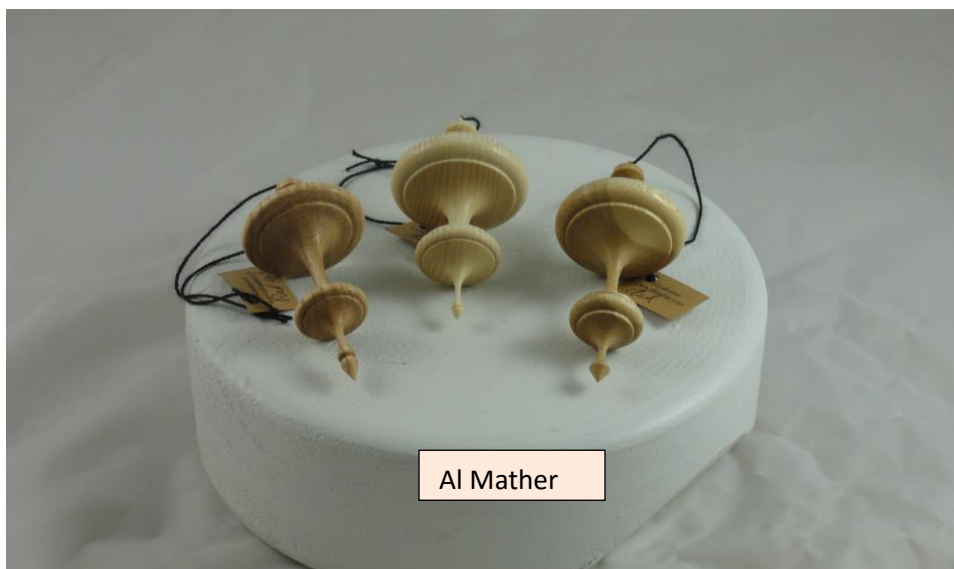



Maine Woodturners  
Brian Libby



Tom Raymond



Don rawnsley



Steve Tofield







Steve Brooke



Jeff Enck





Mac Ray



Lanny Dean



# Don't forget about Eagle Cane Adaptors

Eagle cane adaptors are always needed.

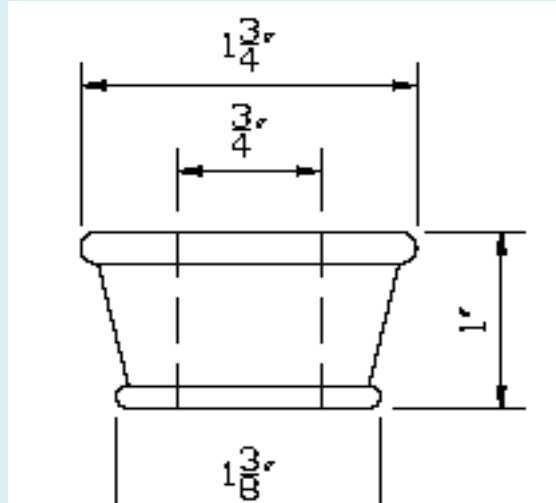

A radius at both top and bottom is desired.  
This makes for a nicer transition.

