



# Maine Woodturners

## Newsletter

MARCH 2016



March Demo will feature :

## Mark Irving

### *Turning a darning egg with a handle*

Mark, past President of MWT, is certainly no stranger to standing behind the lathe and sharing his knowledge of woodturning. He was a teacher at the former "Woodturning School", a demonstrator at The New Hampshire Symposium at Pinkerton Academy and many times at Maine Woodturners here at Erskine Academy.

The darning egg with a handle is one item that Mark sells to the local yarn shop in Bath. It looks like a very simple object to turn, but as you really look at it, it encompasses several turning technics - beads, coves, spindle turning AND the egg shape, which can be a challenge to get the curves "just right".

Mark always gives a very informative and entertaining demo!



**Wednesday – March 16, 2016**

6:30-7:00PM Show & Tell photos and socializing – 7:00PM Demo

All-Purpose Room, Erskine Academy,  
309 Windsor Rd., South China, ME 04358

## SECRETARY'S REPORT

The February 2016 meeting of Maine Woodturners was held at Erskine Academy in South China, Maine on Wednesday the 17th.

President Brian Libby opened the meeting at 7:03 PM by introducing two new members and 2 guests. Thirty eight members and guests were in attendance.

Brian had applied for a grant from AAW for \$1500 for purchase of 2 small lathes for our club. He advised that he received a letter from AAW saying that the grant was approved.

The annual AAW Symposium is scheduled in Atlanta in June.

Brian said that Vice President Al Mather received some recognition for his biscuit cutters on Channel 8 TV recently.

Brian offered copies of handouts from the AAW magazine on making clean cuts.

We should all be thinking about the elections in May for a new Vice President.

Treasurer Burt Truman is collecting membership dues from those who did not pay in November.

Brian announced Kim Dailey from Carthage, Maine as tonight's demonstrator. Kim turned the two segments of his peppermills using ash wood. His demo ended at 8:27 PM.

Brian Hosted the Show and Tell table after the Demo. The meeting ended at 8:40 PM.

Tom Raymond, Sec.

**Elections will soon be upon us !**

**In the even numbered years we elect the  
President and Vice-President**

**In order for the club to function  
we need people to step forward and volunteer**

# SHOW & TELL



Dennis Curtis



Brian Libby



Lanny Dean



Lanny Dean



Don Rawnself



Dick Harvey



Leon Low



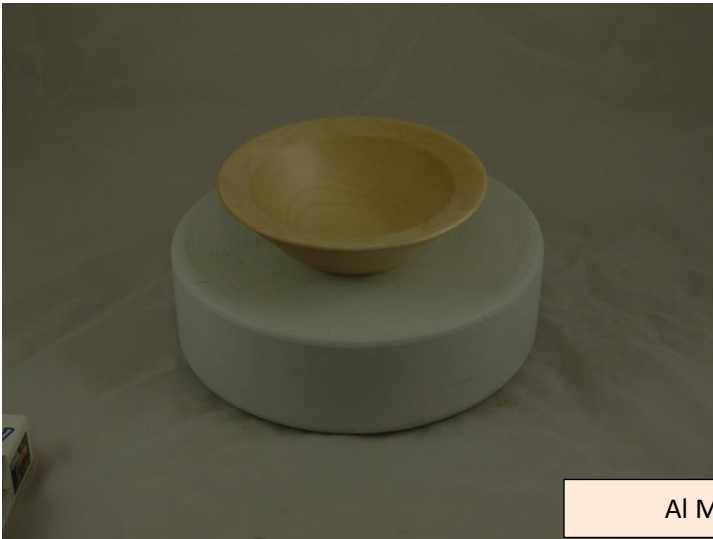

Al Mather



Al Mather



Dan Scott

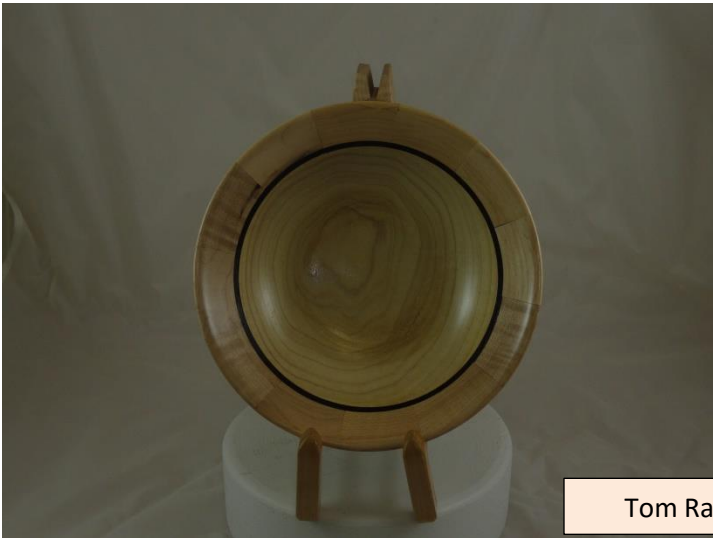

Tom Raymond



# Don't forget about Eagle Cane Adaptors

---

Eagle cane adaptors are always needed.

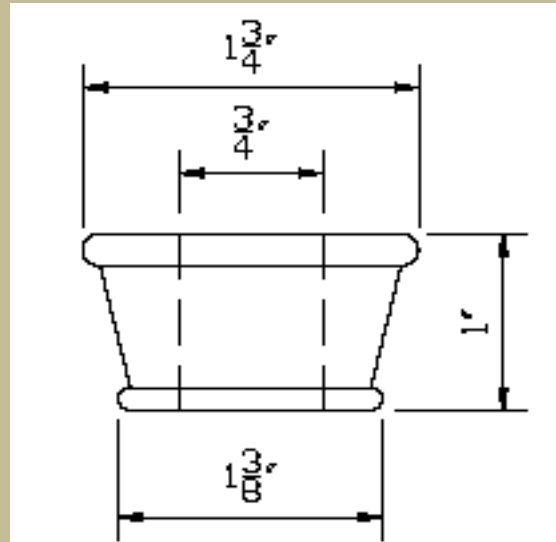

A radius at both top and bottom is desired.  
This makes for a nicer transition .