



Maine Woodturners Newsletter



January 2016

January's Demo will be a "Sharpening Clinic"

Lanny Dean, Steve Brooke and Brian Libby

will have various gouges showing there different cutting angles and edges.

They'll explain what situations they are used in

plus how and why these angles and edges work in each situation.

Members are encouraged to bring a wood turning tool that you're having problems with (doesn't cut right)

Dull tools = frustration

There will be 3 grinders available for hands-on problem solving.

Reminder : this is a Saturday Meeting.

Saturday – January 23, 2016

9:00-9:30AM Show & Tell photos and socializing – 9:30AM Demo

All-Purpose Room, Erskine Academy,
309 Windsor Rd., South China, ME 04358

Don't forget about Eagle Cane Adaptors

Eagle cane adaptors are always needed.

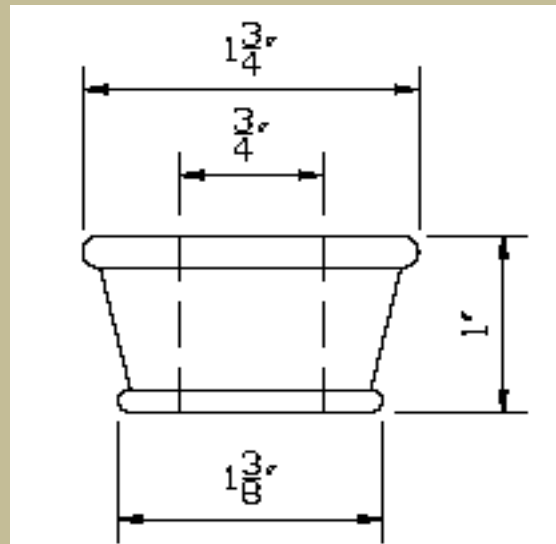

A radius at both top and bottom is desired.
This makes for a nicer transition .