



Maine Woodturners

Newsletter



November - 2015

John Coppola

John Coppola WoodWorks – Rockland, Maine

John is a production turner from Rockland, Maine spending most of his time turning salad tong pairs, pizza wheels, ice cream scoops, bottle openers, and knife handles all with a similar setup. He says, “This allows me to continue working at my lathe rather than stopping and resetting for another item. It’s all about the process and production.”

When asked to demonstrate, John replied:

“I would love to demonstrate for the Maine Woodturners. I figure I could go over the ways I do a few of my production items like utensils, and mini pinch bowls. I’ll demo at least one pair for salad tongs, and the pinch bowls. The pinch bowls start off with a square blank and a drilled forstner bit hole for mounting on extended jaws which help with my efficiency since I can sand both inside and out at the same time.

This should make for an interesting demonstration because it will give us an insight into having one set up to turn a number of different projects.

You can find some of John’s effort through this link:

www.etsy.com/shop/JohnCoppolaWoodWorks?ref=I2-shopheader-name

Wednesday – November 18, 2015

6:30-7:00PM Show & Tell photos and socializing - 7:00PM Demo followed by Show & Tell
All-Purpose Room, Erskine Academy,
309 Windsor Rd., South China, ME 04358

Secretary's Report

by Tom Raymond

The October 2015 meeting of Maine Woodturners was held at Erskine Academy in South China , Maine on Wednesday the 21st. Forty one Members and guests were in attendance.

President Brian Libby opened the meeting at 7:02 PM and announced that there are extra free copies of the AAW magazine on Burt Truman's table. He then announced that former member Steve Gleasner of Appleton, Maine was commended with a big article in the Portland Herald showing a motorcycle he modified using many wood carved components. Steve also teaches at the Center for Furniture Craftsmanship in Rockport.

Brian mentioned that AAW has Grants available to members and that we should apply and possibly purchase 2 small lathes for Saturday training sessions. Show of hands indicted that it was a go ahead.

Chuck Seguin announced that the Eastern Maine woodturners has a Ricon Lathe for sale for \$325. Chuck also works on our website and invites any ideas for improvement.

Thanks to Don Caron who does our photography and to Winston Langdon and Lanny Dean who operated the boom camera at this meeting.

Vice President Al Mather suggested a Saturday session on turning pens in the future.

Brian said membership dues are due at the next meeting. Treasurer Burt Truman collects \$30 from each member.

The demos at this meeting are by 4 members turning small gift items starting with Brian Libby turning a honey dipper and an icicles snowman ornament from .The next demonstrator was Leon Lowell who started turning some small flowers with a skew and green wood. Lanny Dean was next turning a top and a top holder stand. The last Demonstrator was Al Mather turning small Christmas trees using 3 different methods. Al Mather hosted the Show and Tell table until 8:55 PM.

Tom Raymond, Sec

Eagle cane adaptors are always needed.

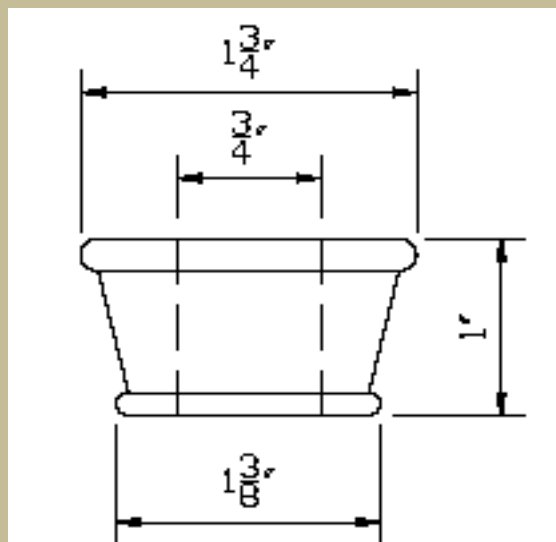

A radius at both top and bottom is desired.
This makes for a nicer transition .

Show & Tell



Tom Raymond



Don Rawnsley





Dan Scott



Damon Harmon

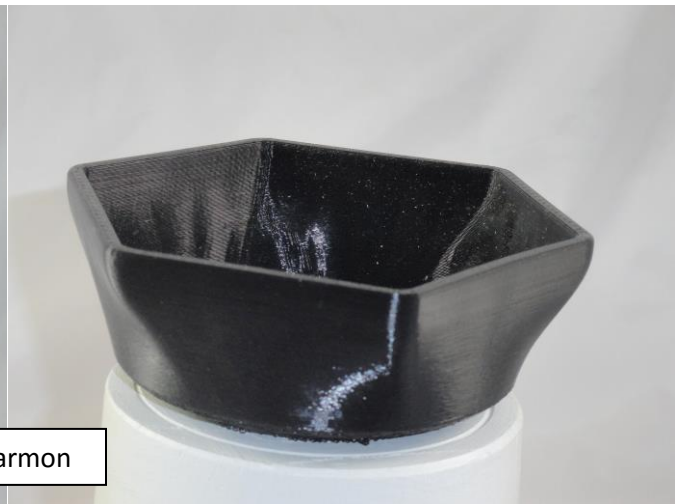

Al Mather





Chuck Seguin



Gary Ouellette



Leon Lowell





Lanny Dean



Brian Libby



Mac Ray

